

# Sycamore Square

[www.sycamoreav.com](http://www.sycamoreav.com)



*Lancaster's Premier Commercial Center*

**MEDICAL / OFFICE CONDOMINIUMS FOR SALE OR LEASE**

44441 - 44509 West 16<sup>th</sup> Street | Lancaster, CA 93534

*For additional information, please contact:*

**Michael Corbin** p: 661.705.2299 ext. 104  
michael.corbin@daumcommercial.com

**Kevin Tamura** p: 661.705.2299 ext. 107  
kevin.tamura@daumcommercial.com

[www. daumcommercial.com](http://www.daumcommercial.com)

- Single Story Buildings
- Garden Style Professional Complex
- Covered Parking Available
- Outstanding Parking Ratios (6.8 / 1,000)
- Generous Buildouts
- Ready for Immediate Occupancy



**DAUM**

Although all information is furnished regarding for sale, rental or financing is from sources deemed reliable, such information has not been verified and no express representation is made nor is any to be implied as to the accuracy thereof, and it is submitted subject to errors, omissions, changes of price, rental or other conditions, prior sale, lease or financing, or withdrawal without notice.

# Sycamore Square

West 16<sup>th</sup> Street | Lancaster, CA

## SITE PLAN

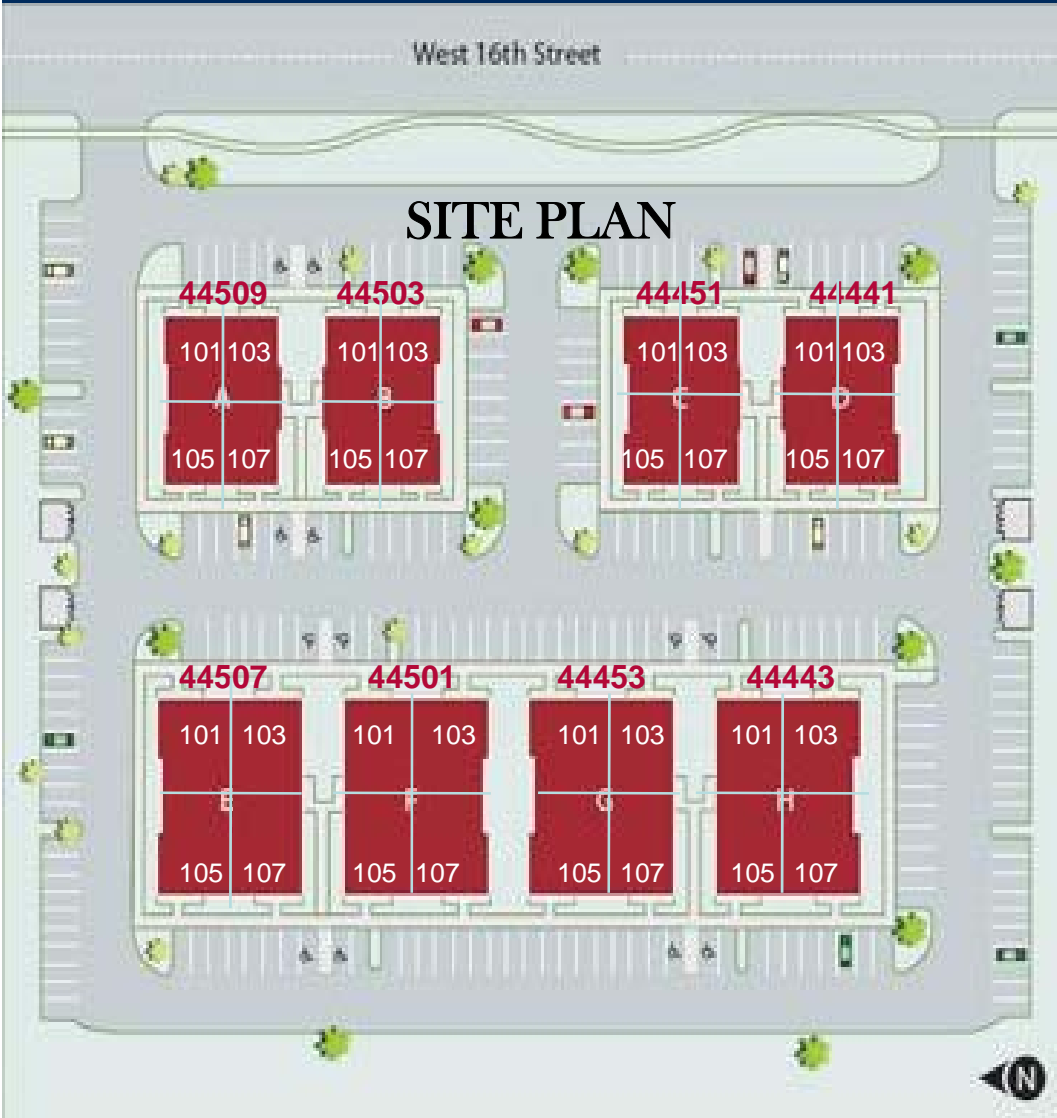

44509 / 44503 / 44451 / 44441:  
4,367 SF (4 Suites)  
3,276 SF (3 Suites)  
2,184 SF (2 Suites)  
1,092 SF (1 Suite)

44507 / 44501 / 44453 / 44443:  
6,373 SF (4 Suites)  
4,780 SF (3 Suites)  
3,187 SF (2 Suites)  
1,594 SF (1 Suite)

### Pricing:

For Lease: \$2.00 PSF / NNN

For Sale: \$250.00 PSF

For Sale: \$225.00 PSF\*

\*when purchasing all four suites

[www.sycamoreav.com](http://www.sycamoreav.com)



Although all information is furnished regarding for sale, rental or financing is from sources deemed reliable, such information has not been verified and no express representation is made nor is any to be implied as to the accuracy thereof, and it is submitted subject to errors, omissions, changes of price, rental or other conditions, prior sale, lease or financing, or withdrawal without notice.